

Projector

Make sure you have the input source is set to the correct VGA input. Some projectors have buttons on top to change the source/input. Usually called Computer or Computer 1. If using a doc cam then make sure it's set to the correct output.

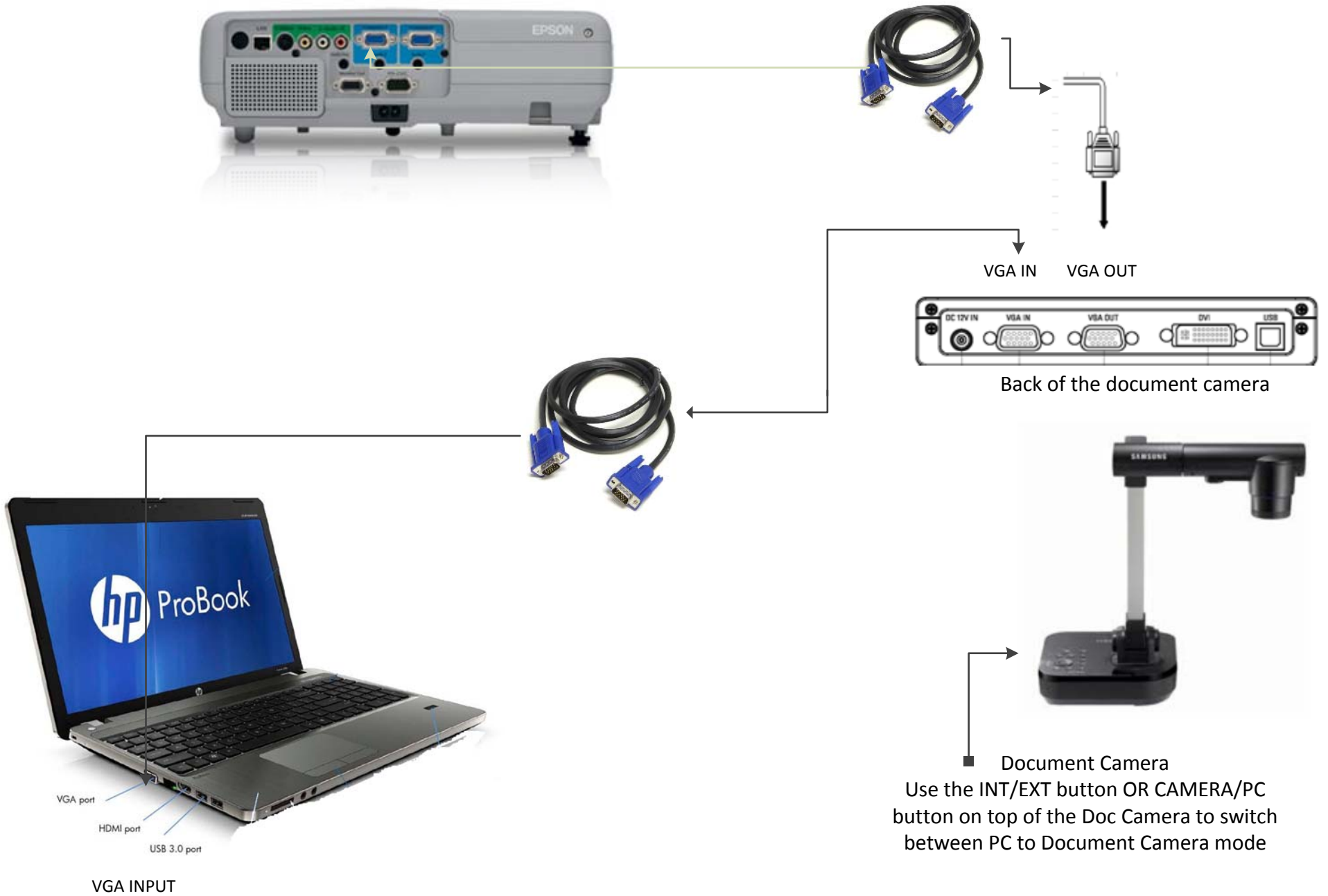

DELL LAPTOPS

Press the FN and F8 function keys at the same time to switch the image from the notebook display, to the external monitor, or to both. This key combination may be different on your computer.

HP LAPTOPS

Switch between displays using notebook function keys
Press the FN and f4 function keys at the same time to switch the image from the notebook display, to the external monitor, or to both. This key combination may be different on your computer.

Switch between displays using Novell Applications

Launch Novell Applications from the shortcut on the desktop
Click the button Clone Displays



VGA INPUT



DELL Fn and F8



HP FN and F4